

Technical Information

- Recessed track supports Stenos directional and ambient modules
- Minimalist and narrow track seamlessly integrates into environments
- Two channel track allows independent dim control for groups of modules when paired with appropriate power supplies
- Snap-in Electrical Joiners include magnetic black/white Cover Plates to maintain clean aesthetic.
- 24 VDC
- Class 2 power supply
- 4A max on track
- 96W max on track
- Dry location only



Finish Options

- Black powder coated
- White powder coated

Product Dimensions

Stenos Track with Mounting Flange

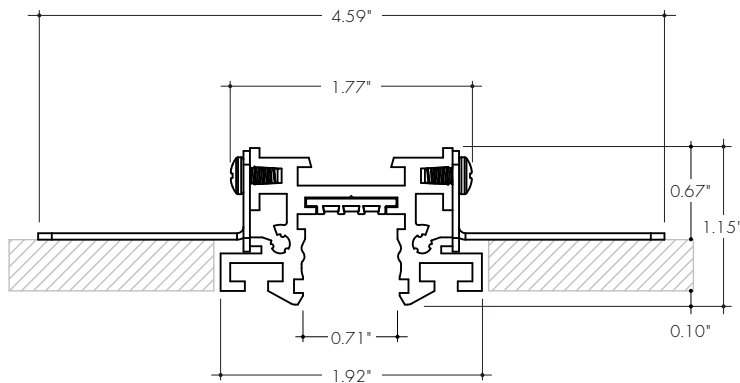

Stenos Track with Mounting Bracket for Hanger Bars or threaded Rod

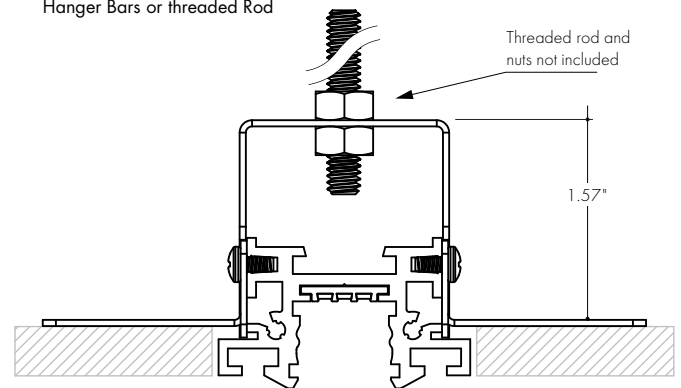

Stenos Track with Directional Module

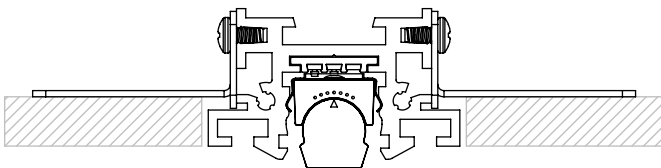

Stenos Track with Ambient Module

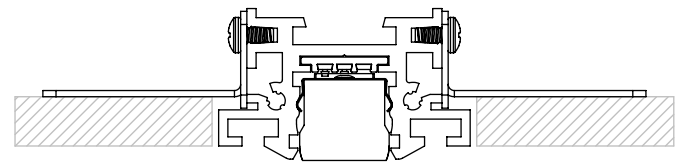

Ordering Code

MODEL	LENGTH	MOUNTING ¹	FINISH
STL-Stenos Recessed Trimless Track	48-48" (4ft) 96-96" (8ft) 144-144" (12ft)	MF-Mounting Flange MB-Mounting Bracket for Hanger bars or Threaded Rod ¹	BK-Black WH-White

¹ - Hanger Bars selected separately.

Track Components

To minimize voltage drop, it is recommended to not exceed 24ft of track per power feed or 3 track joiners per power feed.

EC-STL-H3-XX
Recessed Trimless End Caps

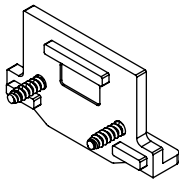

Blank End Cap for ending a Recessed Trimless run

ST-JOIN-M-LB
Mechanical Joiner Brackets

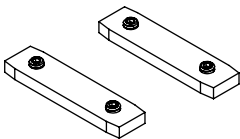

Used for mechanically joining adjacent Track sections

TC-96-XX
Track Cover, 96"

TC-144-XX
Track Cover, 144"

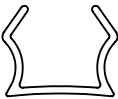

Track Covers ship complete with Recessed Trimless Track and cover unoccupied sections of track. They are field cuttable and can be used to protect channel during the mudding process. Additional can be ordered, if necessary.

JOIN-M-L-STL-XX
Recessed Trimless Mechanical L Joiner

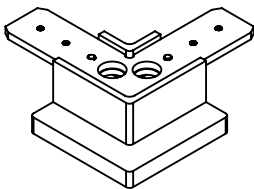

For creating a 90deg in-plane corner

JOIN-M-W-STL-XX
Recessed Trimless Mechanical Wall to Ceiling Joiner

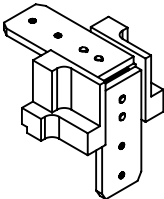

For creating a 90deg Wall to Ceiling corner

MB-STL
Mounting Bracket, Hanger Bar or Threaded Rod

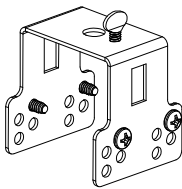

Hanger bars ordered separately. Threaded rod and nuts not included

ST-JOIN-E-P
Electrical Power Feed, with black and white Cover Plates

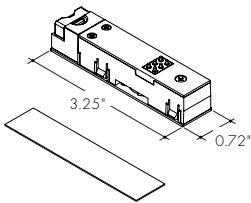

For use with 18AWG field wires with max outer diameter 0.300"

ST-JOIN-E-P-72
Electrical Power Feed, 72" Plenum Cable

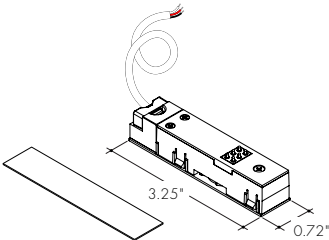

with Black and White cover plates

ST-JOIN-E-S
Electrical Joiner, Straight, with black and white Cover Plates

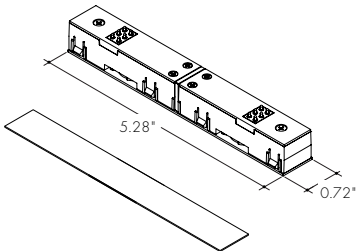

For electrically joining adjacent Track sections

ST-JOIN-E-L
Electrical Joiner, L with black and white Cover Plates

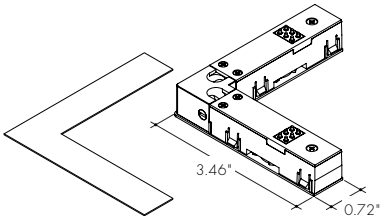

For for use with Mechanical L Joiner

ST-JOIN-E-F
Electrical Joiner, Flexible with black and white Cover Plates

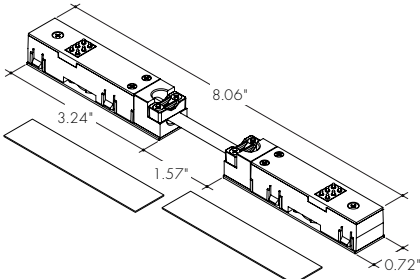

For use with Mechanical L Joiner or Wall to Ceiling Joiner

PF-HB-ALL
Hanger Bars for use with **MB-STL** Mounting Bracket

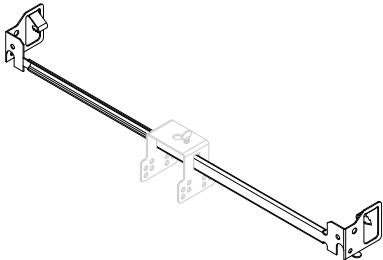

For use to mount to joists. MB-STL not included.

XX	Color
WH	White
BK	Black

Wiring and Multiple Channels

For **single channel** use, connect black and white power feed wires.

For **two channels** use, contact Luminii Sales for power supply selection and wiring instructions

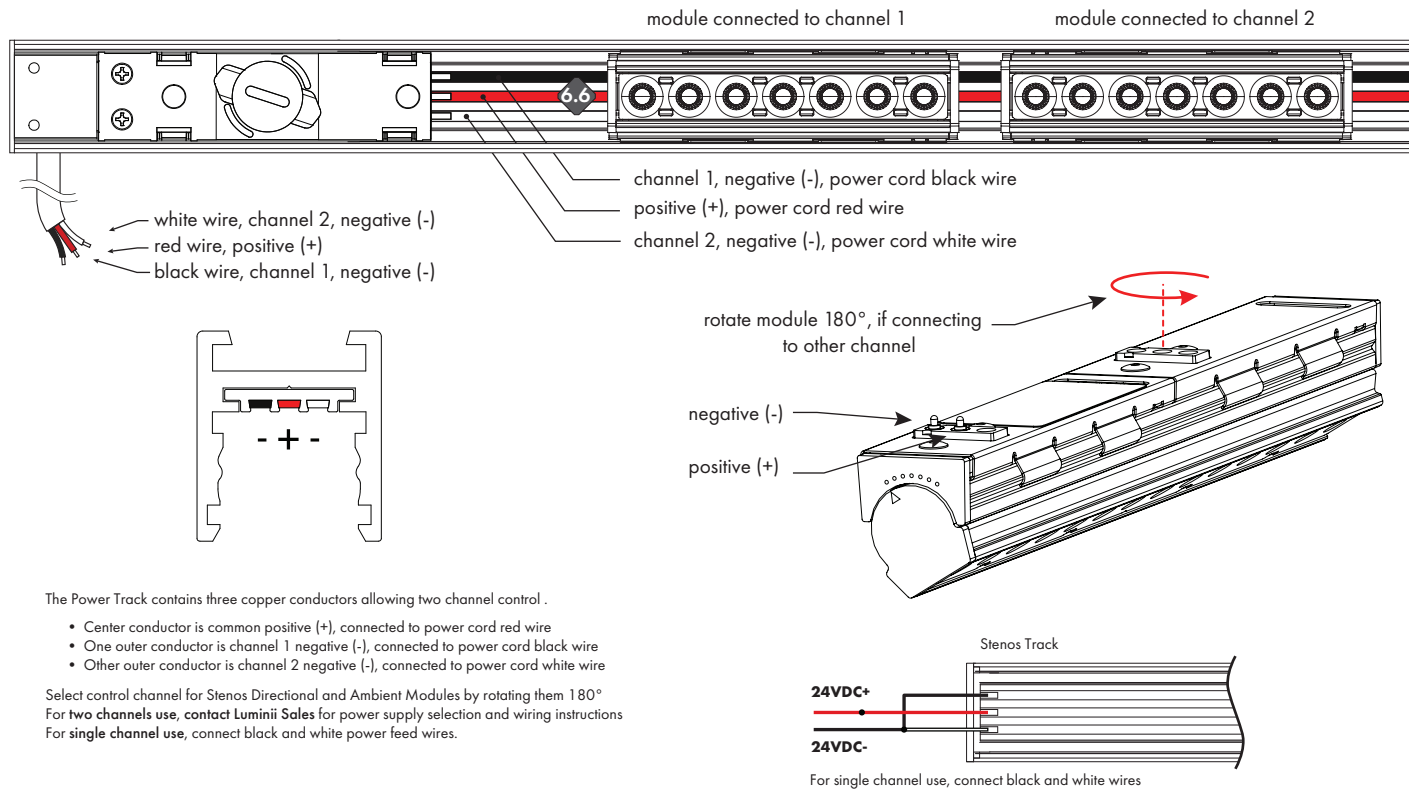

Sample Layout

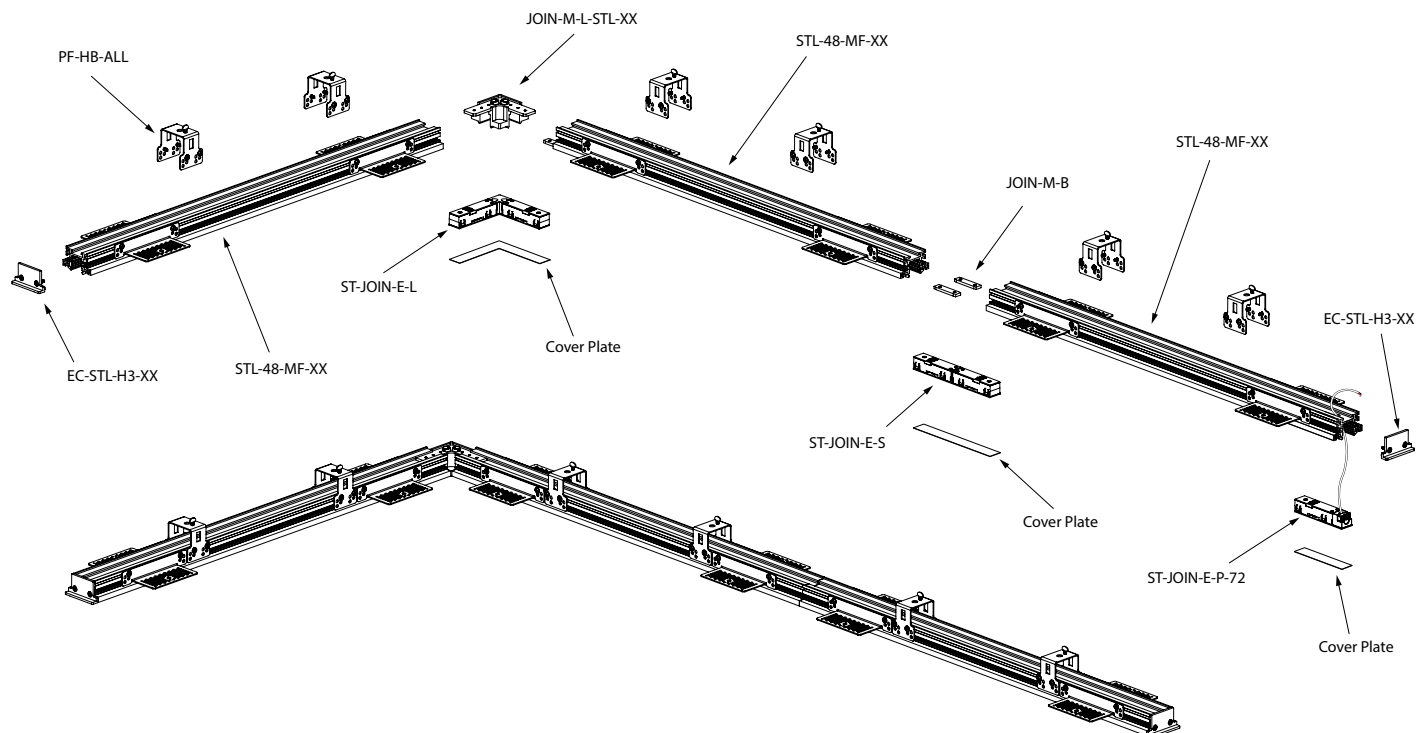

Directional Module

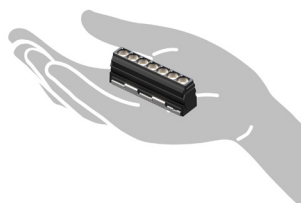
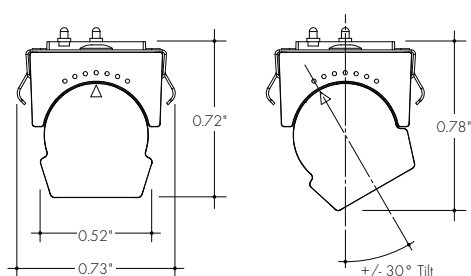
3" Directional Module
shown with Louver

Ambient Module

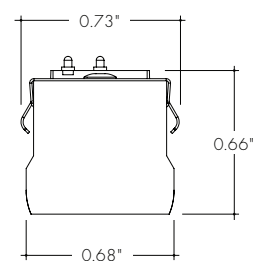

24" Ambient Module

Technical Information

TYPE	Stenos		
OUTPUT OPTIONS (15° Optic)	3	5	12
Lumen Output (3000K)	250 lm	520 lm	1260 lm
Power Consumption	2.6 W	5.4 W	13.0 W
Efficacy (lm/W)	96	96	96
Center Beam Intensity (CBCP)	1500	3100	7700

TYPE	24"		48"	
OUTPUT OPTIONS	SO	HO	SO	HO
Lumen Output (3000K) (with a Frosted Lens)	475 lm	1000 lm	950 lm	2025 lm
Power Consumption	5.5 W	12.3 W	11.0 W	24.7 W
Efficacy	86 lm/W	81 lm/W	86 lm/W	82 lm/W

Ordering Code | Directional Module

MODEL	LENGTH	CCT	OUTPUT	OPTIC ¹	FINISH
SMD-Stenos Directional Module	3-2.5" 5-4.8" 12-11.8"	27K-2700K 30K-3000K 35K-3500K 40K-4000K	SO-Standard	15-15° Optic LV15-15° Louver LV30-30° Louver and Optic LV60-60° Louver and Optic	BK-Black WH-White

¹ - Louvers reduce glare while maintaining 95% of CBCP. Use a 0.6 multiplier for lumen output.

Ordering Code | Ambient Module

MODEL	LENGTH	CCT	OUTPUT	OPTIC*	FINISH
SMA-Stenos Ambient Module	24-24.38" 48-48.00"	27K-2700K 30K-3000K 35K-3500K 40K-4000K	SO-Standard HO-High	F-Frosted L-Louver ¹	BK-Black WH-White

¹ - Louvers reduce glare while maintaining 95% of CBCP. Use a 0.6 multiplier for lumen output.

Power Supplies

See Power Supply instructions and spec sheet for wiring information. For a complete list of compatible dimmers, see Compatible Dimming Chart on the Resources page.

Single Channel Control

Universal Power Supply 1% 120VAC - 277VAC

MODEL	POWER	OUTPUT
PDCU-W-IP66 Wet Series	96-96 W 3X96-3X96 W*	24-24 VDC

0-10V dims down to 1%, MLV/ELV/TRIAC dims down to 1%. For a complete list of compatible dimmers, see [Compatible Dimming Chart](#) on the Resources page. *3X96 uses one set of 0-10V input to control all three outputs together.

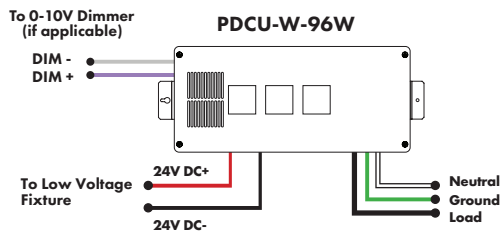

MODELS	PDCU-W-96W	PDCU-W-3X96W
Length	8.66"	11.85"
Width	3.73"	4.32"
Depth	1.61"	1.81"

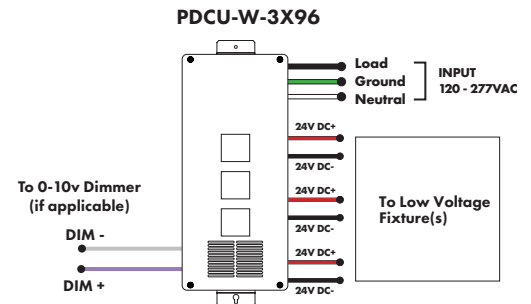

0-10V Dimming Power Supplies 0.1% 120VAC - 277VAC

MODEL	POWER	OUTPUT	DIMMING
PS010V-0-10V Power Supply dims down to 0.1%	96-96 Watt 3X96-3 X 96 Watt	24-24 VDC	LIN-Linear LOG-Logarithmic

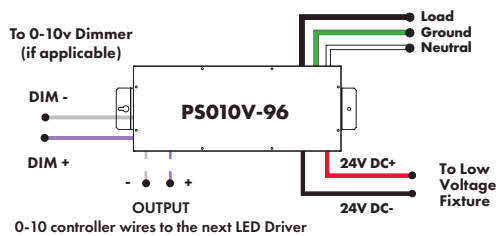

MODELS	96W	3X96
Length	14.40"	15.75"
Width	5.20"	6.62"
Depth	2.60"	4.95"

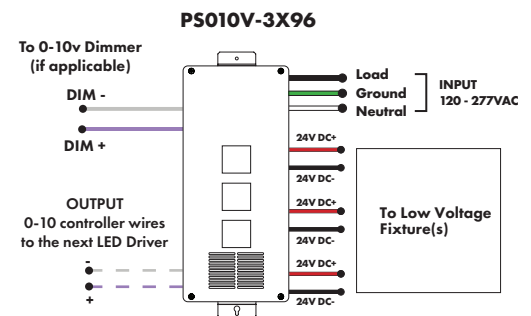

DMX Dimming Power Supplies 120VAC - 277VAC

MODEL	POWER	OUTPUT
PSDMX - DMX Power Supply dims down to 0%	96-96 Watt 3X96-3 X 96 Watt	24-24 VDC

Features eldoLED's LINEARdrive configurable dimmable drivers

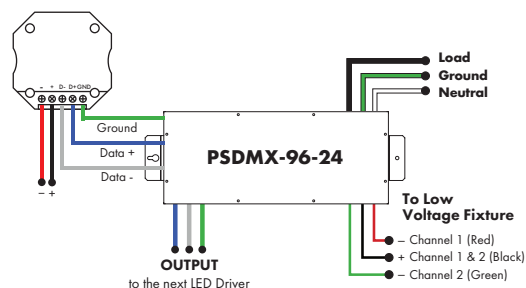

MODELS	96W	3X96
Length	14.40"	15.75"
Width	5.20"	6.62"
Depth	2.60"	4.95"

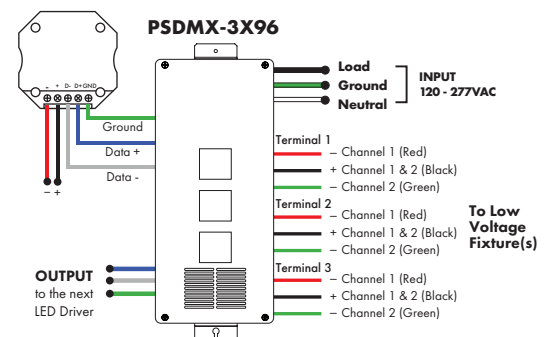

Power Supplies

See Power Supply instructions and spec sheet for wiring information. For a complete list of compatible dimmers, see Compatible Dimming Chart on the Resources page.

DALI 0% Dimming Power Supplies 120VAC - 277VAC

MODEL	POWER	OUTPUT
<div>PSDALI - DALI Power Supply dims down to 0%</div>	<div>96 - 96 Watt 3X96 - 3 X 96 Watt</div>	<div>24 - 24 VDC</div>

Features eldoLED's LINEARdrive configurable dimmable drivers

Model	96W	3X96
Length	14.40"	15.75"
Width	5.20"	6.62"
Depth	2.60"	4.95"

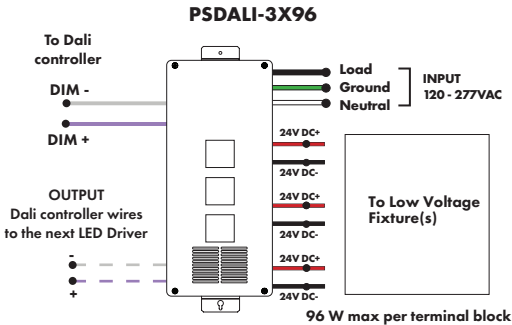
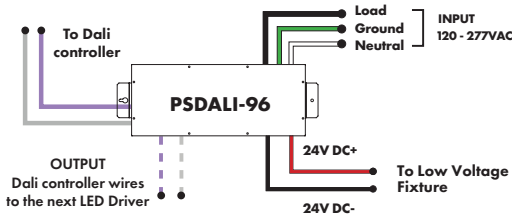

Triac, MLV, & ELV Compatible Dimmers

MODEL	POWER	OUTPUT
<div>PDC - (IP20) Power Supply</div>	<div>96 - 96 Watts</div>	<div>24 - 24 VDC</div>

MODELS	96W
Length	8.25"
Width	4.10"
Depth	1.56"

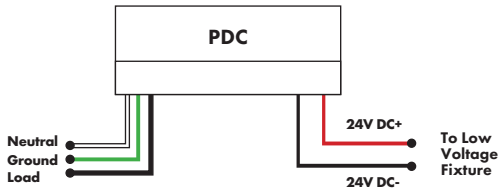

Luminii is a Lutron OEM Advantage Partner

Lutron Power Supplies 1%

MODEL	MODEL
<div>LTEA4U1UKL-CV240</div>	<div>L3DA4U1UKL-CV240</div>
<div>Lutron - HiLume™ 1% 2-wire LED Driver 40W max</div>	<div>HiLume™ 1% EcoSystem Voltage LED driver 40W max</div>

(120V forward phase only)

MODELS	LTEA41UKL-CV240	L3DA4U1UKL-CV240
Length	4.89"	4.98"
Width	4.00"	4.00"
Depth	2.62"	2.62"

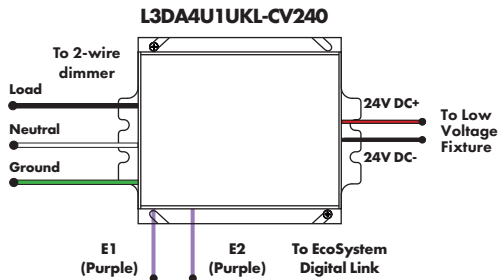
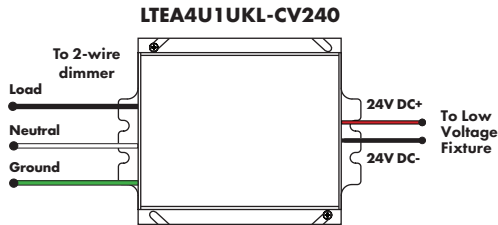

Power Supplies

See Power Supply instructions and spec sheet for wiring information. For a complete list of compatible dimmers, see Compatible Dimming Chart on the Resources page.

Non-Dimming Power Supply 120VAC - 277VAC

MODEL	POWER	OUTPUT	DIMMING	LOCATION
PSV - PSV Series	96 - 96 Watt	24 - 24 VDC	ND - Non Dimming	D - Damp

MODELS 96W

Length	14.40"
Width	5.20"
Depth	2.60"

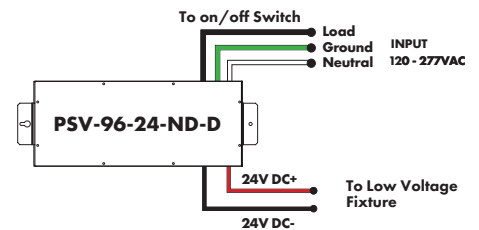

Two Channel Control

0-10V Two Channel Power Supply 120VAC - 277VAC

MODEL	POWER	OUTPUT	CONTROL
PS010-0-10V Vintage Dim Power Supply	96-96 W	24-24 VDC	W2I-Two Channel Independent Intensity Control

MODELS 96W

Length	14.40"
Width	5.20"
Depth	2.60"

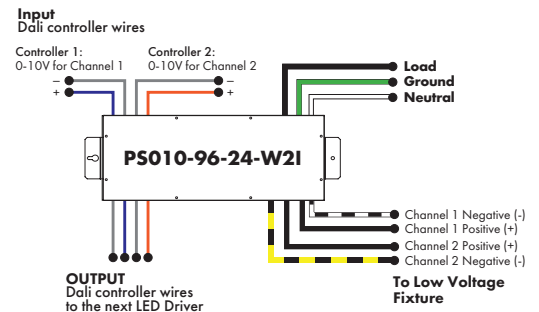

DMX Dimming Power Supplies 120VAC - 277VAC

MODEL	POWER	OUTPUT
PSDMX - DMX Power Supply dims down to 0%	96 - 96 Watt 3X96 - 3 X 96 Watt	24 - 24 VDC

Features eldoLED's LINEARdrive configurable dimmable drivers. 96W max combined between Channel 1 and Channel 2 for each DMX terminal. 2-channel control wiring uses 4 DMX addresses.

MODELS	96W	3X96
Length	14.40"	15.75"
Width	5.20"	6.62"
Depth	2.60"	4.95"

