



Features

- **Narrow, Low-profile**, field-configurable track system supports Stenos directional and ambient modules
- **Flawless** circular beam quality from a unique micro-linear form factor
- Modules seat flush in track for **sleek, sophisticated** effect
- **High Output**: Up to 1200+ lumens per foot
- Enduring **flexibility** – modules can be added, removed, and re-positioned in track easily without special tools
- Two-channel track enables setup of two, separately controllable zones – **simply** remove, rotate, and re-insert a module to change channel
- Class 2 power track **simplifies** installation
- Surface Mount and Recessed track options available
- **Efficient** - Recessed track system is IC rated.

Typical Applications

- Museums
- Hospitality
- Restaurant
- Retail
- High-End Residential
- Corporate Interiors
- Wellness & Healthcare



*T24 compliance requires minimum 50% driver load



Technical Information

- Recessed and Surface Mount track supports Stenos directional and ambient modules
- Minimalist and narrow track seamlessly integrates into environments
- 24 VDC
- Class 2 power supply
- 4A max on track
- 96W max on track

Finish Options



Black Painted



White Painted

Ordering Code | Surface Track

MODEL	LENGTH	MOUNTING	FINISH
STS	48	FC	BK
STS - Stenos S	48 - 48" 96 - 96" 144 - 144"	FC - Fixed Clip	BK - Black WH - White

All Stenos track includes necessary mounting hardware.

Ordering Code | Recessed Track

MODEL	LENGTH	MOUNTING	FINISH
STR	48	GS	BK
STR - Stenos R	48 - 48" 96 - 96" 144 - 144"	GS - Gypsum Surface Mounting Bracket	BK - Black WH - White

All Stenos track includes necessary mounting hardware.

Track Style & Dimensions

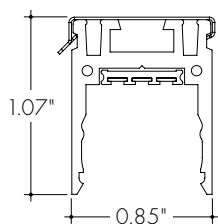

Surface Track

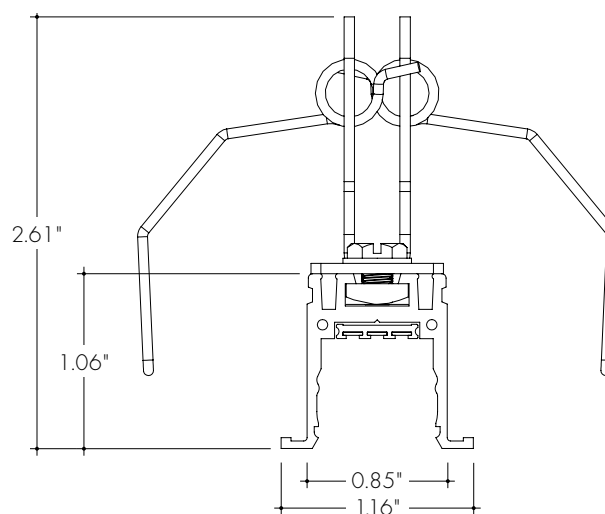

Recessed Track

Luminii recommends not to exceed 24ft or 3 track joiners per power feed to minimize system voltage drop and avoid output variation across the run. Long runs of track can be accomplished using multiple power feeds.

Track Components

All accessories sold separately, except mounting clips & spring brackets, which are included with track. Power feed endcaps and joiners will occupy about 1" of available track.

TJ-1-72

Track Power Feed 72" Length Plenum Rated Cable

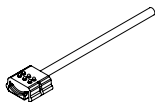

Track Power Feed Cable to be used in combination with any joiner to convert into a Power Feed Joiner. Power Feed Endcaps already included TJ-1-72.

PF-ST5-[BK/WH]

Power Feed Endcap - Surface

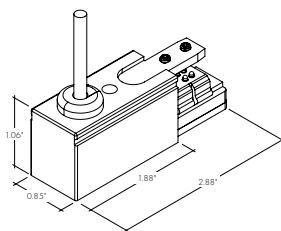

PF-STR-[BK/WH]

Power Feed Endcap - Recessed

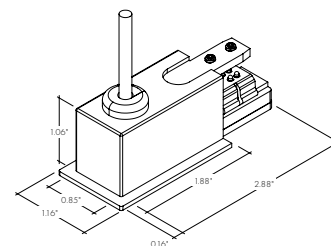

JOIN-S-ST5-[BK/WH]

Straight Joiner - Surface

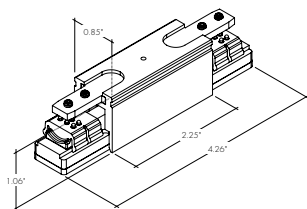

JOIN-S-STR-[BK/WH]

Straight Joiner - Recessed

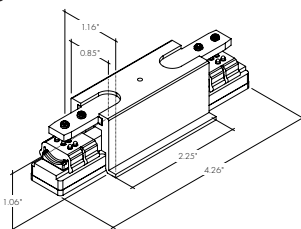

JOIN-L-ST5-[BK/WH]

L Joiner - Surface

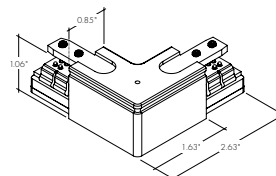

JOIN-L-STR-[BK/WH]

L Joiner - Recessed

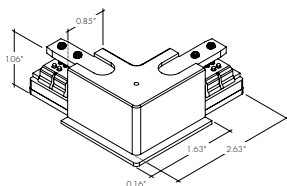

JOIN-T-ST5-[BK/WH]

T Joiner - Surface, Consult Factory

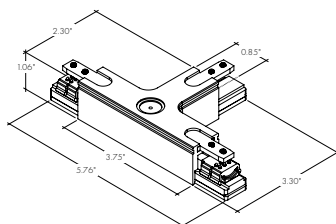

JOIN-T-STR-[BK/WH]

T Joiner - Recessed, Consult Factory

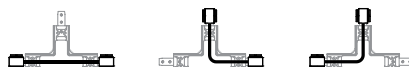
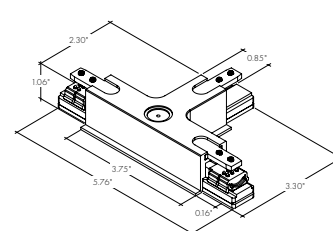

JB4-ST5-[BK/WH]

4" Junction Box Cover Kit for Power Feed End Cap

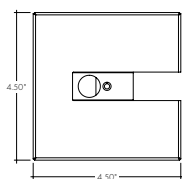

JOIN-X-STR-[BK/WH]

X Joiner - Recessed, Consult Factory

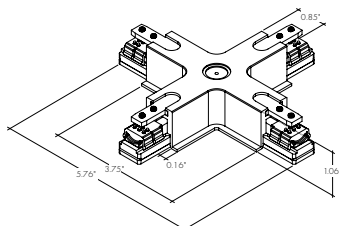

JOIN-X-ST5-[BK/WH]

X Joiner - Surface, Consult Factory

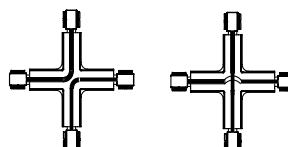
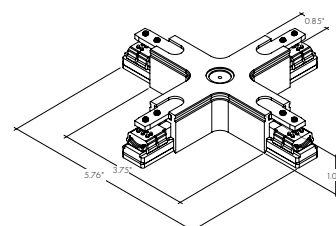

Track Components

All accessories sold separately, except mounting clips & spring brackets, which are included with track. Power feed endcaps and joiners will occupy about 1" of available track.

EC-ST5-H3-[BK/WH]
Blank Endcap - Surface

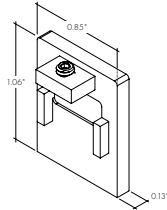

EC-STR-H3-[BK/WH]
Blank Endcap - Recessed

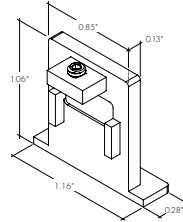

MB-ST5-[BK/WH]
Surface Mount Fixed Clip



Surface mounting clips are included with Surface Mount Track. Shown here only if extras are needed.

TC-96-[BK/WH]
TC-144-[BK/WH]
Track Filler, 96" or 144"

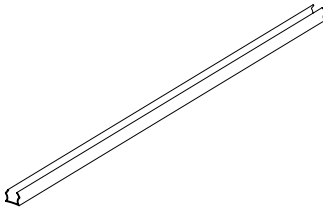

Track fillers ship complete with the Track and cover unoccupied sections of the Track. They are field cuttable and can be used to protect the channel during installation. Additional can be ordered, if necessary.

MB-STR
Recessed Mount Torsion Spring Bracket
Sold as pairs
One pair needed per 2' of track length.

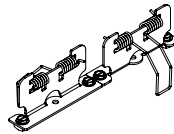

Spring Brackets are included with recessed track. Shown here only if extras are needed.

Wiring and Multiple Channels

For **single channel** use, connect black and white power feed wires.

For **two channels** use, contact Luminii Sales for power supply selection and wiring instructions

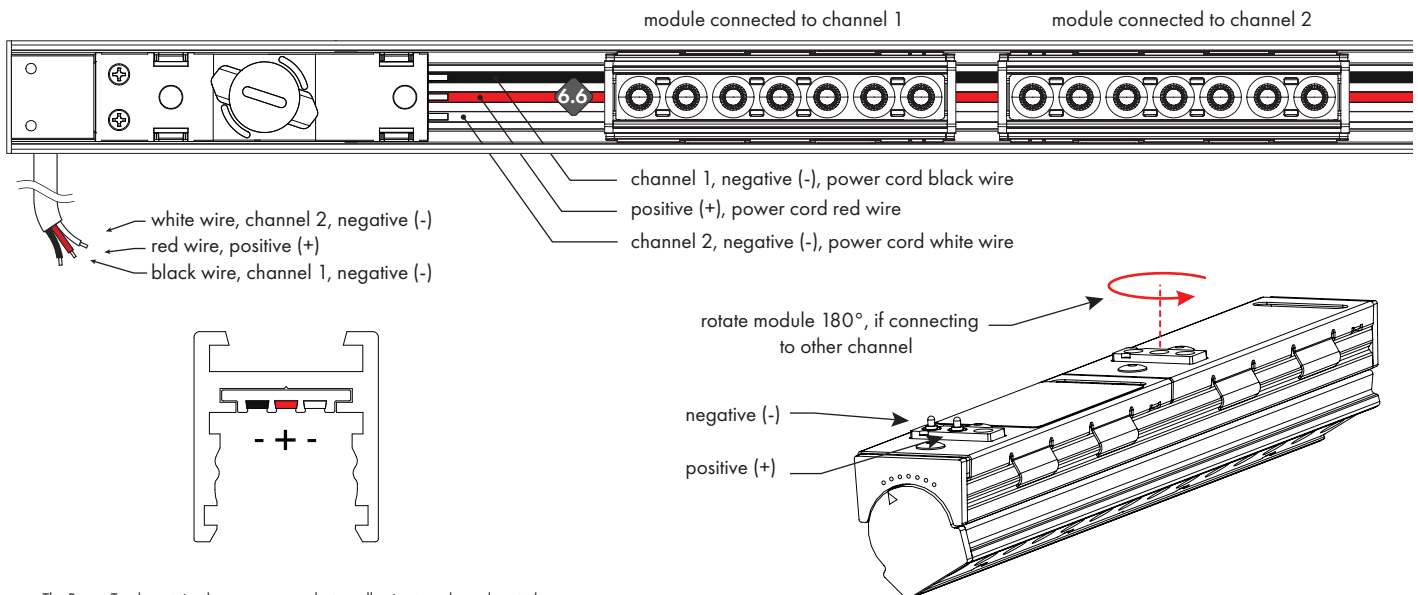

The Power Track contains three copper conductors allowing two channel control .

- Center conductor is common positive (+), connected to power cord red wire
- One outer conductor is channel 1 negative (-), connected to power cord black wire
- Other outer conductor is channel 2 negative (-), connected to power cord white wire

Select control channel for Stenos Directional and Ambient Modules by rotating them 180°
For two channels use, contact Luminii Sales for power supply selection and wiring instructions
For single channel use, connect black and white power feed wires.

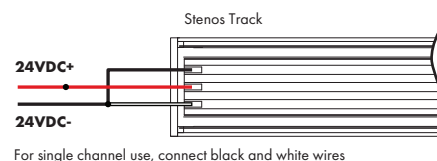

Directional Module

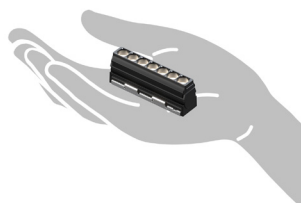
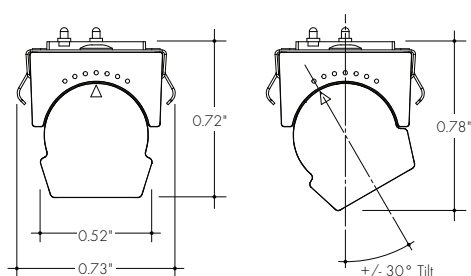
3" Directional Module
shown with Louver

Ambient Module

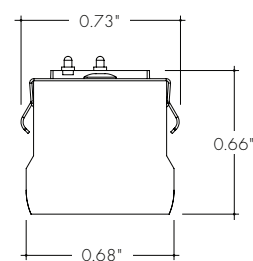
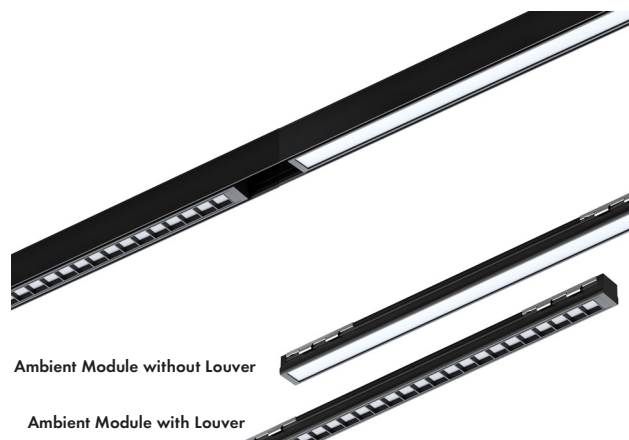

24" Ambient Module

Technical Information

TYPE	Stenos		
OUTPUT OPTIONS (15° Optic)	3	5	12
Lumen Output (3000K)	250 lm	520 lm	1260 lm
Power Consumption	2.6 W	5.4 W	13.0 W
Efficacy (lm/W)	96	96	96
Center Beam Intensity (CBCP)	1500	3100	7700

TYPE	24"		48"	
OUTPUT OPTIONS	SO	HO	SO	HO
Lumen Output (3000K) (with a Frosted Lens)	475 lm	1000 lm	950 lm	2025 lm
Power Consumption	5.5 W	12.3 W	11.0 W	24.7 W
Efficacy	86 lm/W	81 lm/W	86 lm/W	82 lm/W

Ordering Code | Directional Module

MODEL	LENGTH	CCT	OUTPUT	OPTIC ¹	FINISH
SMD-Stenos Directional Module	3-2.5" 5-4.8" 12-11.8"	27K-2700K 30K-3000K 35K-3500K 40K-4000K	SO-Standard	15-15° Optic LV15-15° Louver LV30-30° Louver and Optic LV60-60° Louver and Optic	BK-Black WH-White

¹ - Louvers reduce glare while maintaining 95% of CBCP. Use a 0.6 multiplier for lumen output.

Ordering Code | Ambient Module

MODEL	LENGTH	CCT	OUTPUT	OPTIC*	FINISH
SMA-Stenos Ambient Module	24-24.38" 48-48.00"	27K-2700K 30K-3000K 35K-3500K 40K-4000K	SO-Standard HO-High	F-Frosted L-Louver ¹	BK-Black WH-White

¹ - Louvers reduce glare while maintaining 95% of CBCP. Use a 0.6 multiplier for lumen output.

Power Supplies

See Power Supply instructions and spec sheet for wiring information. For a complete list of compatible dimmers, see Compatible Dimming Chart on the Resources page.

Single Channel Control

Universal Power Supply 1% 120VAC - 277VAC

MODEL	POWER	OUTPUT
PDCU-W-IP66 Wet Series	96-96 W 3X96-3X96 W*	24-24 VDC

0-10V dims down to 1%, MLV/ELV/TRIAC dims down to 1%. For a complete list of compatible dimmers, see [Compatible Dimming Chart](#) on the Resources page. * 3X96 uses one set of 0-10V input to control all three outputs together.

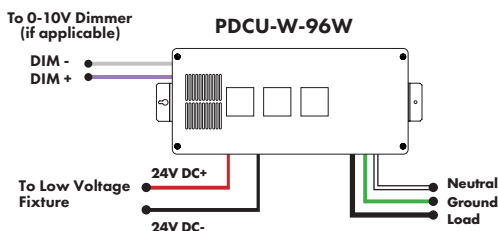

MODELS	PDCU-W-96W	PDCU-W-3X96W
Length	8.66"	11.85"
Width	3.73"	4.32"
Depth	1.61"	1.81"

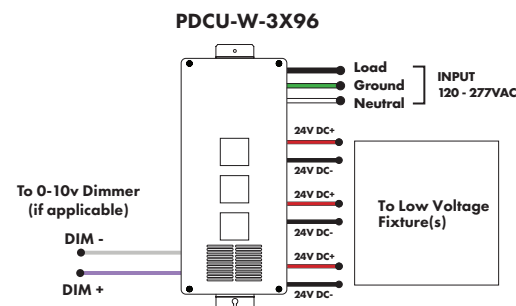

0-10V Dimming Power Supplies 0.1% 120VAC - 277VAC

MODEL	POWER	OUTPUT	DIMMING
PS010V-0-10V Power Supply dims down to 0.1%	96-96 Watt 3X96-3 X 96 Watt	24-24 VDC	LIN-Linear LOG-Logarithmic

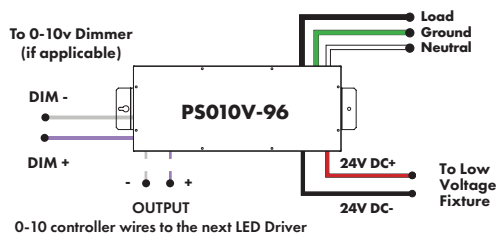

MODELS	96W	3X96
Length	14.40"	15.75"
Width	5.20"	6.62"
Depth	2.60"	4.95"

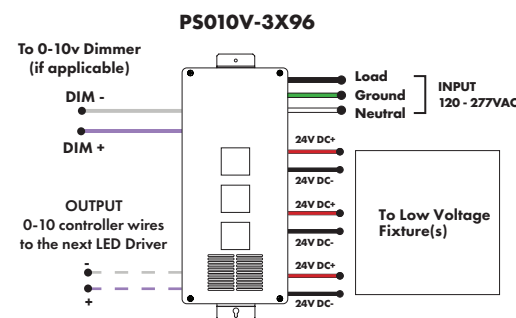

DMX Dimming Power Supplies 120VAC - 277VAC

MODEL	POWER	OUTPUT
PSDMX - DMX Power Supply dims down to 0%	96-96 Watt 3X96-3 X 96 Watt	24-24 VDC

Features eldoLED's LINEARdrive configurable dimmable drivers

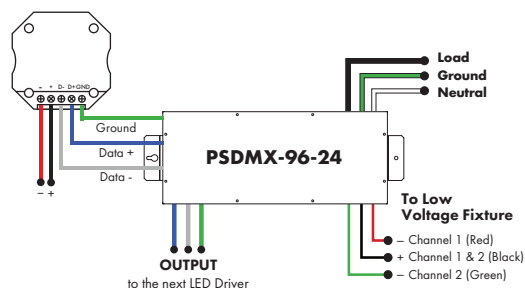

MODELS	96W	3X96
Length	14.40"	15.75"
Width	5.20"	6.62"
Depth	2.60"	4.95"

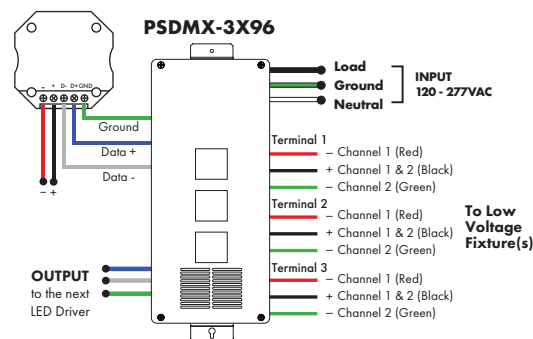

Power Supplies

See Power Supply instructions and spec sheet for wiring information. For a complete list of compatible dimmers, see Compatible Dimming Chart on the Resources page.

DALI 0% Dimming Power Supplies 120VAC - 277VAC

MODEL	POWER	OUTPUT
PSDALI - DALI Power Supply dims down to 0%	96 - 96 Watt 3X96 - 3 X 96 Watt	24 - 24 VDC

Features eldoLED's LINEARdrive configurable dimmable drivers

Model	96W	3X96
Length	14.40"	15.75"
Width	5.20"	6.62"
Depth	2.60"	4.95"

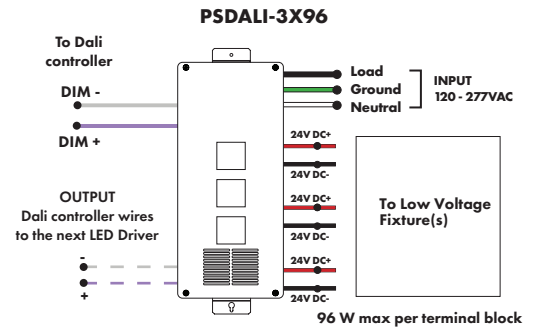
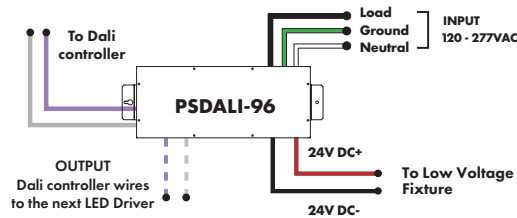

Triac, MLV, & ELV Compatible Dimmers

MODEL	POWER	OUTPUT
PDC - (IP20) Power Supply	96 - 96 Watts	24 - 24 VDC

MODELS	96W
Length	8.25"
Width	4.10"
Depth	1.56"

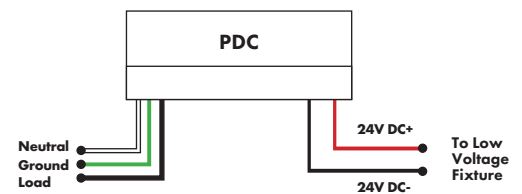

Luminii is a Lutron OEM Advantage Partner

Lutron Power Supplies 1%

MODEL	MODEL
LTEA4U1UKL-CV240	L3DA4U1UKL-CV240
Lutron - HiLume™ 1% 2-wire LED Driver 40W max	HiLume™ 1% EcoSystem Voltage LED driver 40W max

(120V forward phase only)

MODELS	LTEA41UKL-CV240	L3DA4U1UKL-CV240
Length	4.89"	4.98"
Width	4.00"	4.00"
Depth	2.62"	2.62"

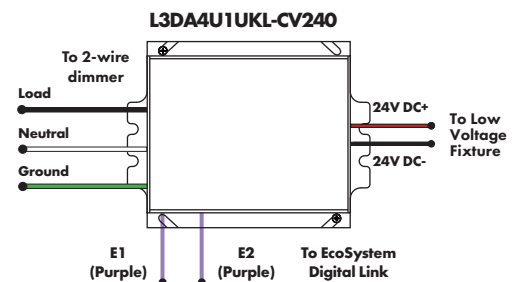
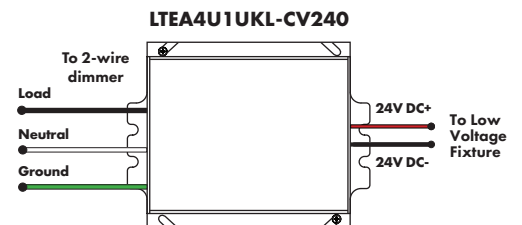

Power Supplies

See Power Supply instructions and spec sheet for wiring information. For a complete list of compatible dimmers, see Compatible Dimming Chart on the Resources page.

Non-Dimming Power Supply 120VAC - 277VAC

MODEL	POWER	OUTPUT	DIMMING	LOCATION
PSV - PSV Series	96 - 96 Watt	24 - 24 VDC	ND - Non Dimming	D - Damp

MODELS 96W

Length	14.40"
Width	5.20"
Depth	2.60"

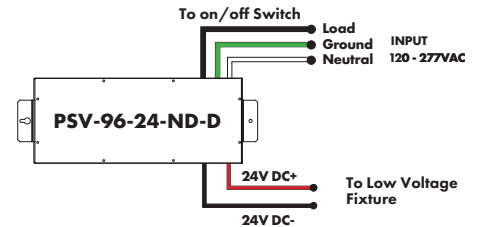

Two Channel Control

0-10V Two Channel Power Supply 120VAC - 277VAC

MODEL	POWER	OUTPUT	CONTROL
PS010-0-10V Vintage Dim Power Supply	96-96 W	24-24 VDC	W2I-Two Channel Independent Intensity Control

MODELS 96W

Length	14.40"
Width	5.20"
Depth	2.60"

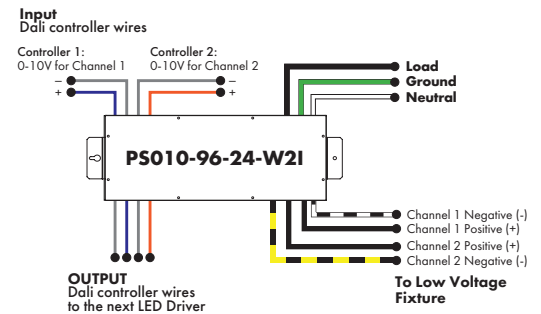

DMX Dimming Power Supplies 120VAC - 277VAC

MODEL	POWER	OUTPUT
PSDMX - DMX Power Supply dims down to 0%	96 - 96 Watt 3X96 - 3 X 96 Watt	24 - 24 VDC

Features eldoLED's LINEARdrive configurable dimmable drivers. 96W max combined between Channel 1 and Channel 2 for each DMX terminal. 2-channel control wiring uses 4 DMX addresses.

MODELS	96W	3X96
Length	14.40"	15.75"
Width	5.20"	6.62"
Depth	2.60"	4.95"

