



Technical Information

- Surface Mount Track supports Stenos directional and ambient modules
- Minimalist and narrow track seamlessly integrates into environments
- Two circuit track allows independent dim control for groups of modules when paired with appropriate power supplies
- Snap-in Electrical Joiners include magnetic black/white Cover Plates to maintain clean aesthetic.
- Connect to 24V DC SELV
- 4 amp max on track
- IP20

Finish Options

- ☒ Black powder coated
☐ White powder coated



RoHS



UK CA



Product Dimensions

Stenos Track

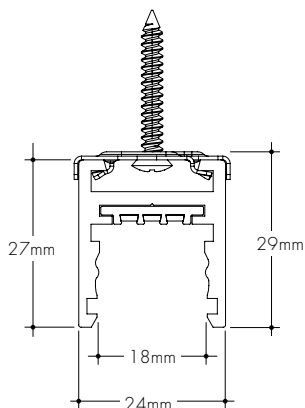

Stenos Track with Ambient Module

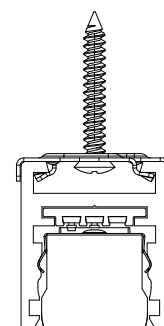

Stenos Track with Directional Module

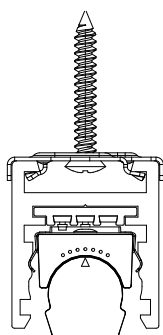

Stenos Track with Directional Module with louver

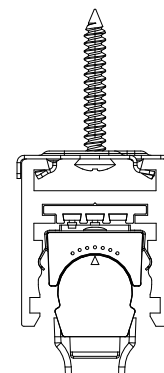

Ordering Code

MODEL	LENGTH	MOUNTING	FINISH
STS - Stenos Surface Track	1M - 1 meter 2M - 2 meter	SF - Surface Mount	BK - Black WH - White

Stenos track includes necessary mounting clips and screws.

Track Components

To minimize voltage drop, it is recommended to not exceed 732cm of track per power feed or 3 track joiners per power feed.

EC-ST5-H3-SF-XX
Surface End Caps

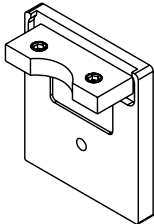

Blank End Cap for ending a Surface run

ST-JOIN-M-TB
Surface Mechanical Joiner Bracket

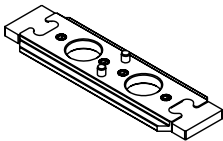

Used for mechanically joining adjacent Track sections

TC-1M-XX
Track Cover, 1 meter

TC-2M-XX
Track Cover, 2 meter

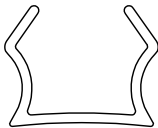

Track Covers ship complete with Surface Track and cover unoccupied sections of track. They are field cuttable. Additional can be ordered, if necessary

JOIN-M-L-ST5-XX
Surface Mechanical L Joiner

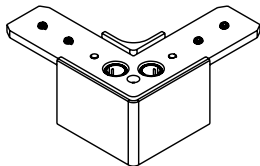

For creating a 90° in-plane corner

JOIN-M-W-ST5-XX
Surface Mechanical Wall-to-Ceiling Joiner

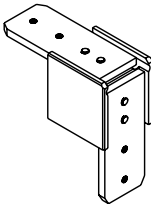

For creating a 90° Wall to Ceiling corner

XX	Color
WH	White
BK	Black

ST-JOIN-E-P
Electrical Power Feed, with black and white Cover Plates

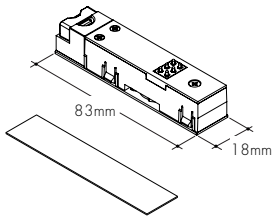

For use with 18AWG field wires with max outer diameter Ø8mm

ST-JOIN-E-S
Electrical Joiner, Straight, with black and white Cover Plates

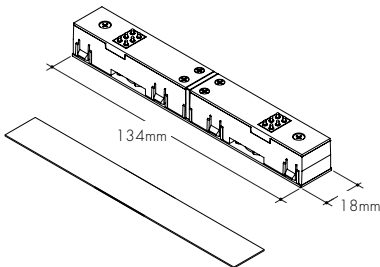

For electrically joining adjacent Track sections

ST-JOIN-E-L
Electrical Joiner, L with black and white Cover Plates

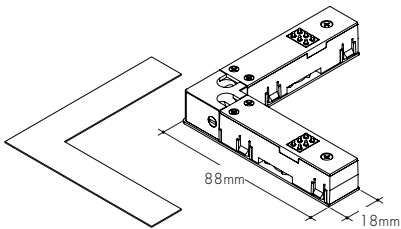

For for use with Mechanical L Joiner

ST-JOIN-E-F
Electrical Joiner, Flexible with black and white Cover Plates

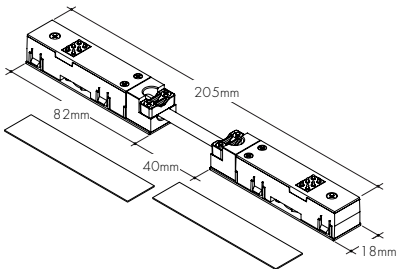

For use with Mechanical L Joiner or Wall to Ceiling Joiner

Wiring and Multiple Circuits

Power Feed Cord (24VDC)

For single circuit use, connect black and white Power Feed Cord wires.

For two circuit control, pair with Power Supplies PS010TW-96-24, PSDMX-96-24, PSDALI-DT8-96-24, or PSDMX-3X96-24.

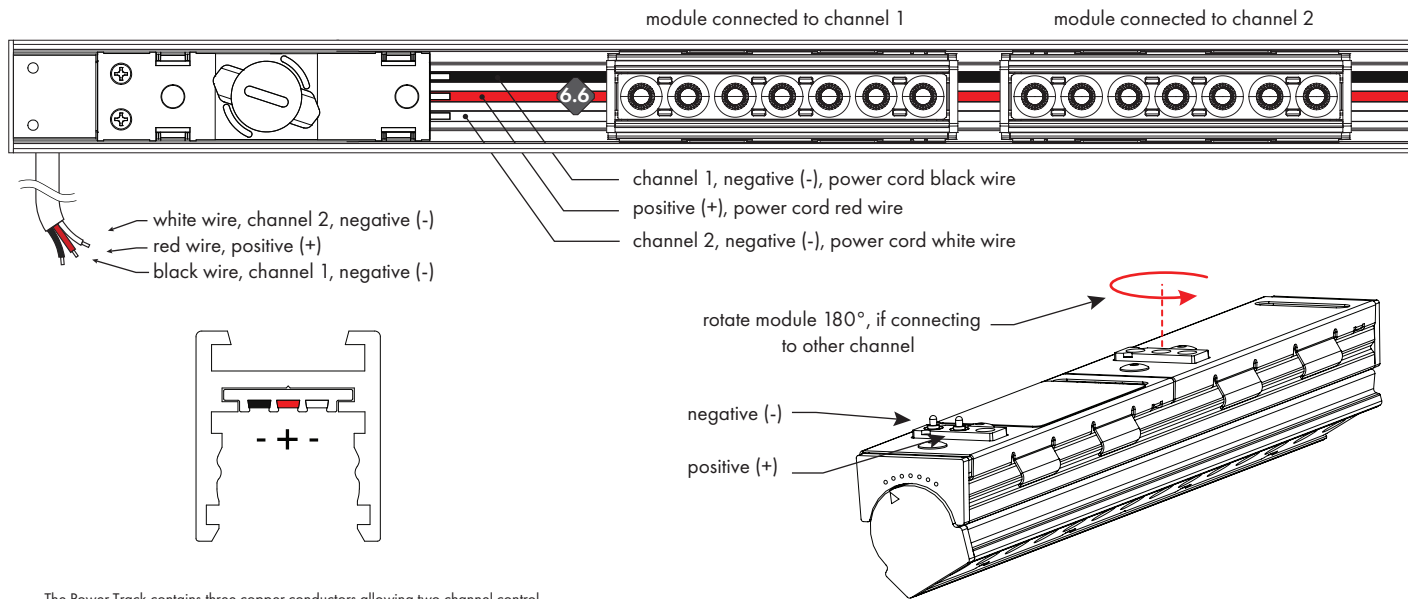

The Power Track contains three copper conductors allowing two channel control.

- Center conductor is common positive (+), connected to power cord red wire
- One outer conductor is channel 1 negative (-), connected to power cord black wire
- Other outer conductor is channel 2 negative (-), connected to power cord white wire

Select control channel for Stenos Directional and Ambient Modules by rotating them 180°

For two channels use, contact Luminii Sales for power supply selection and wiring instructions

For single channel use, connect black and white power feed wires.

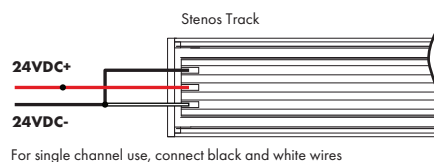

Sample Layout

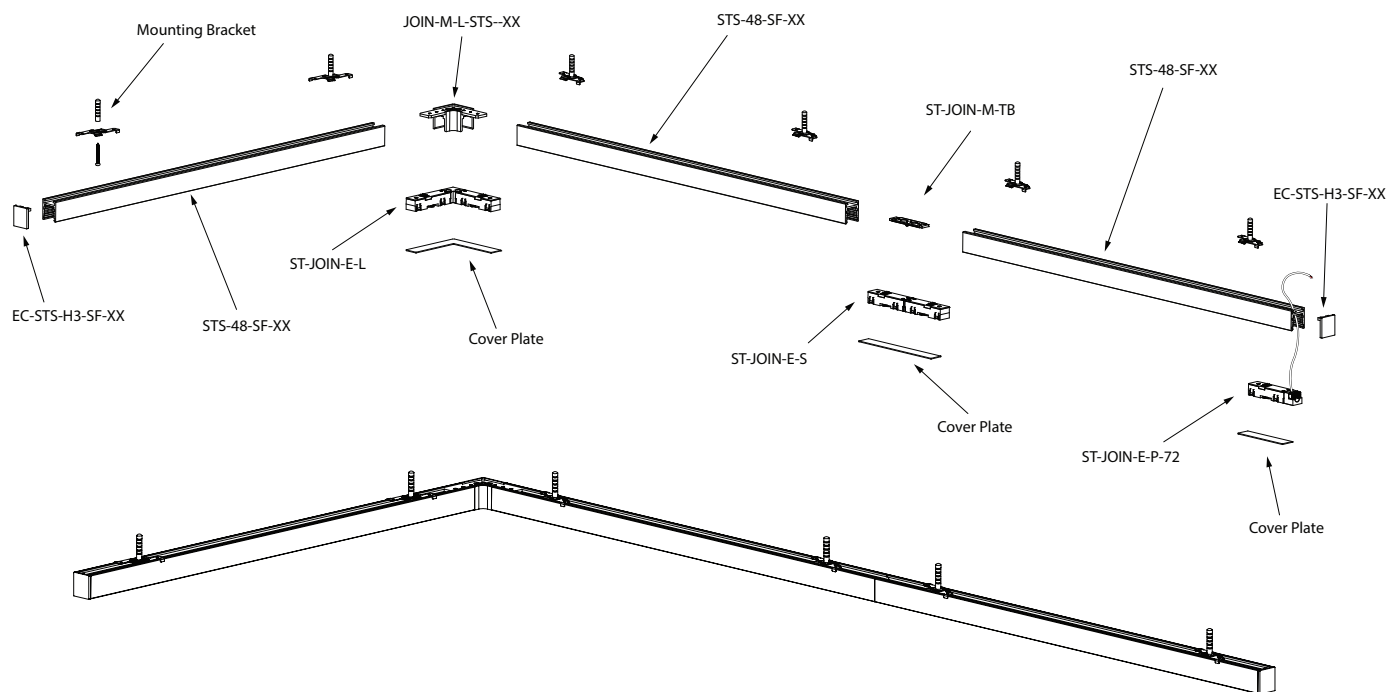

Directional Module

Ambient Module

Ambient Module without Louver

Ambient Module with Louver

Technical Information

TYPE	Stenos		
OUTPUT OPTIONS ^(15° Optic)	3	5	12
Lumen Output (3000K)	250 lm	520 lm	1260 lm
Power Consumption	2.6 W	5.4 W	13.0 W
Efficacy (lm/W)	96	96	96
Center Beam Intensity (CBCP)	1500	3100	7700

TYPE	24		48	
OUTPUT OPTIONS	SO	HO	SO	HO
Lumen Output (3000K) ^(with a Frosted Lens)	475 lm	1000 lm	950 lm	2025 lm
Power Consumption	5.5 W	12.3 W	11.0 W	24.7 W
Efficacy	86 lm/W	81 lm/W	86 lm/W	82 lm/W

Ordering Code | Directional Module

MODEL	LENGTH	CCT	OUTPUT	OPTIC*	FINISH
SMD-Stenos Directional Module	3-64mm 5-122mm 12-300mm	27K-2700K 30K-3000K 35K-3500K 40K-4000K	SO-Standard	15-15° Optic LV15-15° Louver LV30-30° Louver and Optic LV60-60° Louver and Optic	BK-Black WH-White

1 - Louvers reduce glare while maintaining 95% of CBCP. Use a 0.6 multiplier for lumen output.

Ordering Code | Ambient Module

MODEL	LENGTH	CCT	OUTPUT	OPTIC	FINISH
SMA-Stenos Ambient Module	24-610mm 48-1219mm	27K-2700K 30K-3000K 35K-3500K 40K-4000K	SO-Standard HO-High	F-Frosted L-Louver ¹	BK-Black WH-White

1 - Louvers reduce glare while maintaining 95% of CBCP. Use a 0.6 multiplier for lumen output.

Power Supplies

See Power Supply instructions and spec sheet for wiring information. For a complete list of compatible dimmers, see [Compatible Dimming Chart](#) on the Resources page.

Universal Power Supply 1% 120VAC - 277VAC

MODEL	POWER	OUTPUT
PDCU-W-IP66 Wet Series	96-96 W 3X96-3X96 W*	24-24 VDC

0-10V dims down to 1%, MLV/ELV/TRIAC dims down to 1%. For a complete list of compatible dimmers, see [Compatible Dimming Chart](#) on the Resources page. *3X96 uses one set of 0-10V input to control all three outputs together.

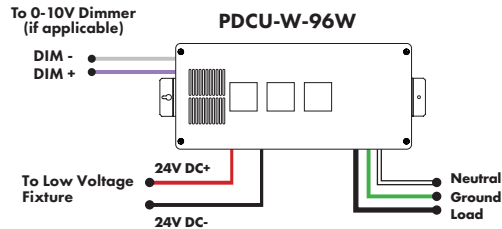

MODELS	PDCU-W 96W	PDCU-W 3X96W
Length	220mm	301mm
Width	95mm	110mm
Depth	41mm	46mm

PDCU-W-3X96

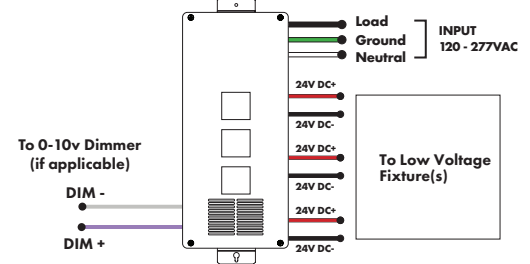

0-10V Dimming Power Supplies 1.0% 120VAC - 277VAC

MODEL	POWER	OUTPUT	DIMMING

Contact Factory for Osram 0-10V 100W/150W Power Supply options.

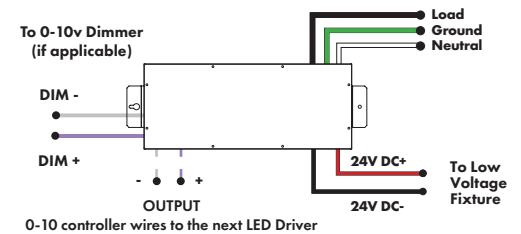

0-10V Dimming Power Supplies 0.1% 120VAC - 277VAC

MODEL	POWER	OUTPUT	DIMMING

Contact Factory for eldoLED 0-10V 96W/3X96W Power Supply options featuring eldoLED's LINEARdrive configurable dimmable drivers.

MODELS	96W	3X96W	100W	150W
Length	367mm	400mm	TBD	TBD
Width	132mm	168mm	TBD	TBD
Depth	66mm	126mm	TBD	TBD

PS010V-3X96

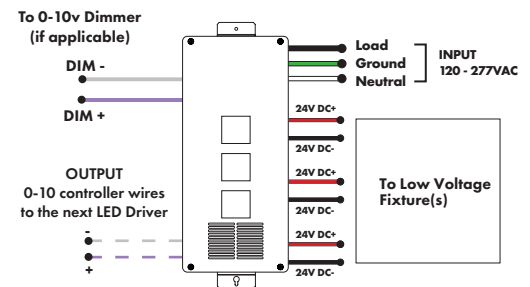

DALI 0% Dimming Power Supplies 120VAC - 277VAC

MODEL	POWER	OUTPUT

Contact Factory for eldoLED Dali Power Supply options featuring eldoLED's LINEARdrive configurable dimmable drivers.

Model	96W	3X96W
Length	366mm	400mm
Width	132mm	168mm
Depth	66mm	126mm

